



## Thomas SR 52

### *Precision. Power. Performance.*

You want a trusted name when it comes to providing engineered power transmission products that improve productivity and efficiency. Rexnord provides superior products for your industrial applications world wide. We work closely with you to reduce maintenance costs, eliminate redundant inventories and prevent equipment downtime.

### *Applications include:*

- ▶ pumps
- ▶ compressors
- ▶ industrial fans

### *Thomas SR 52*

The Rexnord Thomas Series 52 is a general purpose high speed high torque disc coupling. Available as a standard flexible membrane coupling or in special designs including torsionally tuned, breaker pin, electrically insulated, brake drum and brake disc.



Ex II 2G T5

# Thomas SR 52

## Features

- ▶ Unitized disc pack (Tpack\*)
- ▶ High torque to O.D. ratio
- ▶ Easy alignment

## Benefits

- ▶ Ease of installation
- ▶ High speed potential
- ▶ Ease of installation

\* T-Pack available for 225-750

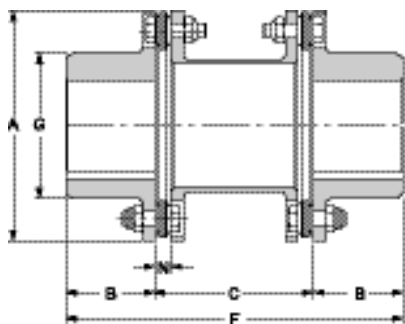
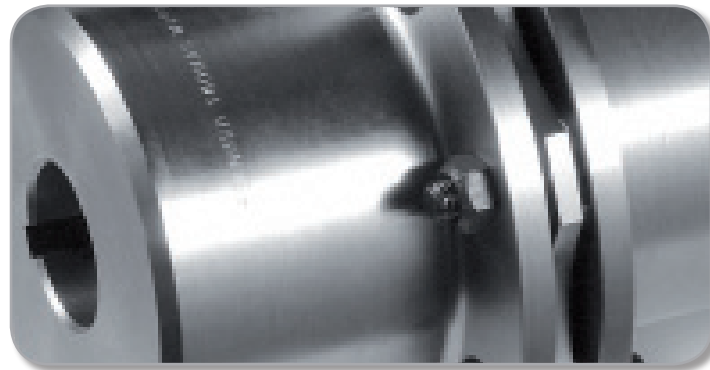

Torque Demands Driven Machine	Typical Application for Electric Motor or Turbine Driven Equipment	Typical Service Factor
	Constant torque such as centrifugal pumps blowers and compressors	1.0
	Continuous duty with some torque variations including plastic extruders and forced draft fans	1.5
	Light shock loads from metal extruders, cooling towers and log haulers	2.0
	Moderate shock loading as expected from a car dumper, stone crusher, vibrating screen	2.5
	Heavy shock load with some negative torques from reciprocating pumps, compressors, reversing turnout tables	3.0
	Frequent torque reversals such as reciprocating compressors with frequent torque reversals which do not necessarily include reverse rotations	Consult Rexnord Engineering

### General Dimensions (mm)

Coupling Size	Stocked C				Max Bore (mm)	A (mm)	B (mm)	Min. C (mm)	F (mm)	G (mm)	N (mm)	Axial capacity (mm)
	100 (mm)	140 (mm)	180 (mm)	250 (mm)								
125	•				34	94	33,3	-	168	52	7	±0,91
162	•	•			50	110	44,5	52	216	70	7	±0,91
200	•	•			58	138	52,3	67	232	83	9	±0,91
225	•	•	•		70	145	66,8	70	260	96	9	±0,91
262		•	•		84	168	73,2	82	273	114	12	±1,09
312		•	•		97	198	85,9	95	311	133	13	±1,29
350			•	•	110	221	95,3	106	343	149	14	±1,42
375			•	•	120	246	101,6	117	381	165	15	±1,57
425			•	•	130	267	108,0	125	394	178	16	±1,70
450			•	•	140	287	114,3	136	432	189	18	±1,82
500					146	327	127,0	153	483	213	20	±2,02
550					166	367	139,7	175	533	240	23	±2,33
600					176	406	152,4	191	559	260	25	±2,59

### Engineering data

Coupling Size	Max RPM		Max Continuous Torque (Nm)	Peak Overload Torque (Nm)	Weight (Kg.)	WR <sup>2</sup> (kgm <sup>2</sup> )	WR <sup>2</sup> Change Per mm of „C“ (kgm <sup>2</sup> /m)	Weight Change Per m of „C“ (Kg)
	Not Balanced	Balanced						
125	5 000	15 000	305	610	2,1	0,002	0.002	2,86
162	4 600	15 000	604	1 208	3,3	0,005	0.003	3,75
200	4 250	15 000	1 185	2 371	5,6	0,013	0.007	4,47
225	4 100	14 000	1 976	3 951	7,3	0,018	0.010	6,26
262	3 900	13 000	3 706	7 413	11,8	0,040	0.018	8,94
312	3 450	11 700	5 803	11 605	18,8	0,088	0.036	11,80
350	3 200	10 500	7 552	15 105	26,6	0,088	0.055	14,84
375	3 000	9 400	11 323	22 646	36,3	0,266	0.083	18,41
425	2 800	8 700	15 161	30 323	47,2	0,404	0.135	25,56
450	2 700	8 100	16 979	33 958	57,7	0,576	0.156	25,74
500	2 500	7 100	27 817	55 633	89,0	1,112	0.313	41,11
550	2 300	6 300	37 300	74 599	127,6	2,019	0.495	51,83
600	2 150	5 700	48 973	97 945	168,0	3,277	0.705	58,98



**REXNORD NV, Belgium**

Dellingstraat 55

**2800 Mechelen**

Phone: +32 / 15 44 38 11

Fax: +32 / 15 44 38 60

E-mail: CSB@rexnord.com

[www.rexnord.eu](http://www.rexnord.eu)

## Contact